

**LEGEND**

- Streams
- 5' Elevation Contours
- Property Lines
- Project Area
- Parking & Access

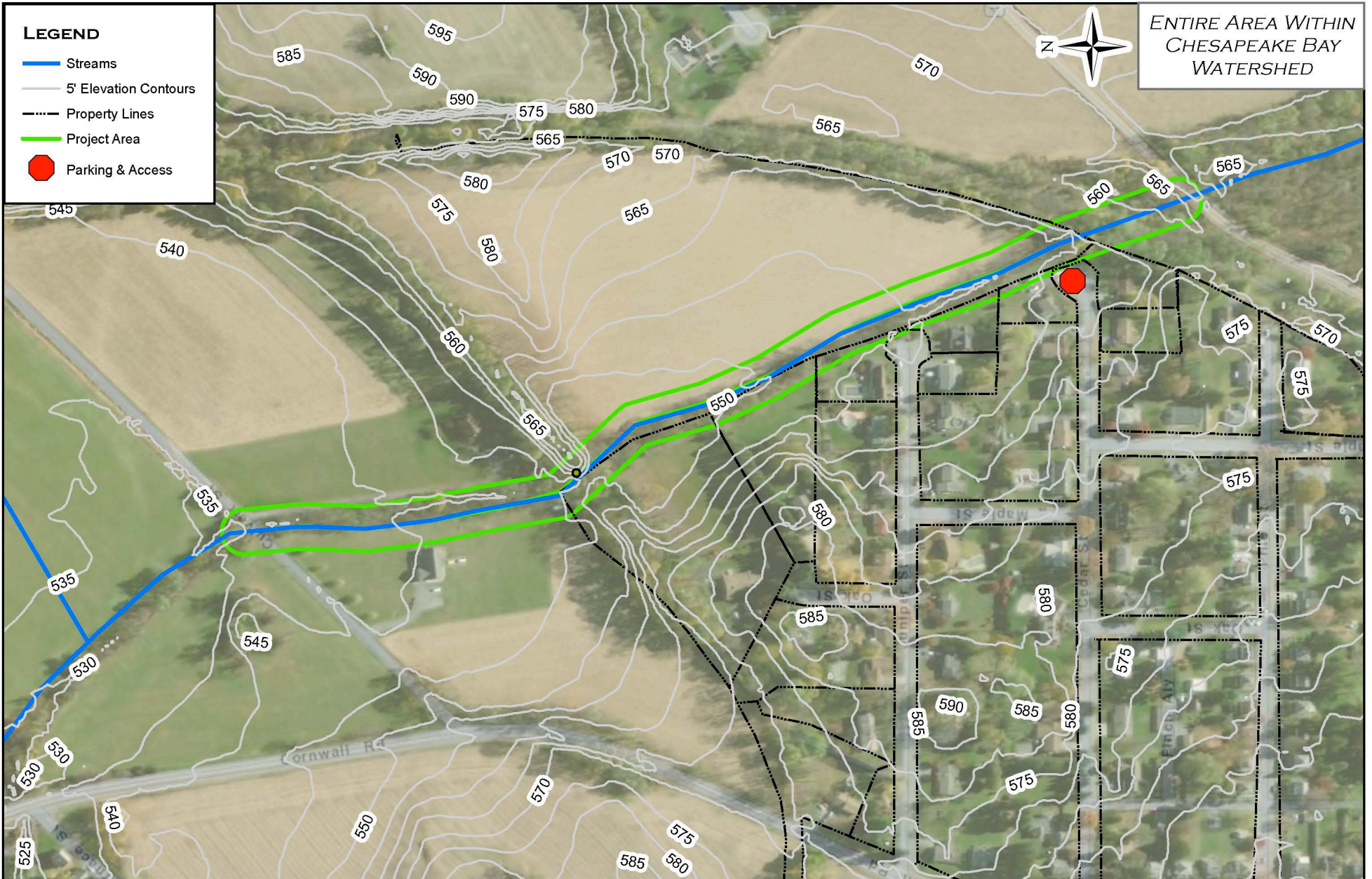

ENTIRE AREA WITHIN  
CHESAPEAKE BAY  
WATERSHED



SITE MAP

# SNITZ CREEK 2

DATE: JUNE 2018

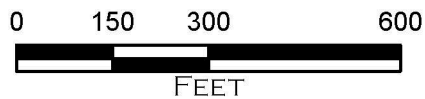

SNITZ CREEK,  
QUITTAPAHILLA CREEK WATERSHED,  
LEBANON COUNTY, PA

PREPARED BY:



CLEAR CREEKS CONSULTING  
1317 Knopp Road, Jarrettsville, Maryland 21084  
(410) 692-2164